



OAK HAVEN  
STUDIO  
986 COLE STREET  
MACON, GA 31201  
478.747.0250

**CLIFFVIEW PARK**  
MACON, GA 31206



KEY PLAN:

REVISIONS:		
#	DATE	DESCRIPTION
1	11-14-23	ADDENDUM 1

DATE: SEPTEMBER 22, 2023

PROTECTION &  
DEMOLITION PLAN

SHEET:

**L0.3**

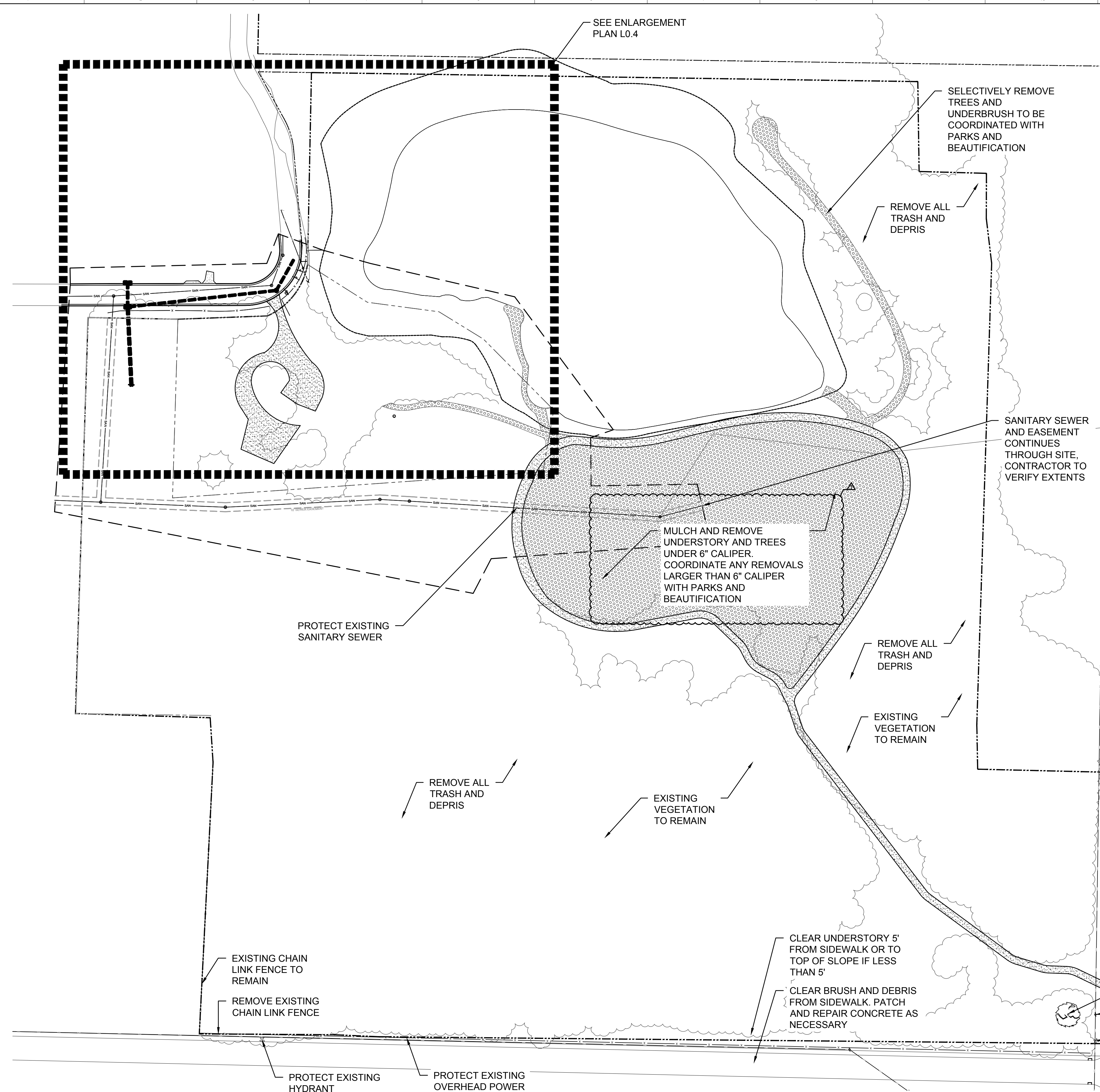

**PROTECTION LEGEND**

- PROTECT EXISTING OVERHEAD POWER LINE AND POLES
- PROTECT EXISTING SEWER LINE
- PROTECT EXISTING HYDRANT
- PROTECT EXISTING WATER METER

**DEMOLITION LEGEND**

- REMOVE EXISTING CHAIN LINK FENCE
- CLEAR AND GRUB VEGETATION

**NOTES**

1. CONTRACTOR SHALL FIELD VERIFY ALL DEMOLITION WITH OWNER'S REPRESENTATIVE PRIOR TO CONSTRUCTION.
2. THE CONTRACTOR IS PUT ON NOTICE THAT CONDITIONS MAY EXIST UNDERGROUND THAT ARE NOT SHOWN IN THE CONSTRUCTION PLANS INCLUDING, BUT NOT LIMITED TO, LIGHTING, SANITARY SEWER, STORM SEWER, GAS LINES, & IRRIGATION CONDUITS. THE CONTRACTOR SHALL IMMEDIATELY NOTIFY THE OWNER'S REPRESENTATIVE IF UNANTICIPATED CONDITIONS ARE ENCOUNTERED DURING CONSTRUCTION.
3. ADJUST ALL EXISTING UTILITY MANHOLE COVERS, VALVE BOXES, FIRE HYDRANTS AND UTILITY BOXES TO FINAL GRADE.
4. CONTRACTOR SHALL PROVIDE FOR EROSION CONTROL PER STATE AND LOCAL CODES DURING DEMOLITION.
5. THOROUGHLY CLEAN ALL AREAS AND SURFACES IMPACTED BY DEMOLITION PRIOR TO START OF NEW CONSTRUCTION.
6. LANDSCAPE ARCHITECT ASSUMES NO RESPONSIBILITY FOR BURIED UTILITIES. CONTRACTOR IS RESPONSIBLE FOR LOCATING AND PROTECTING ALL UTILITIES PRIOR TO AND DURING CONSTRUCTION.

