

GATEWAY PARK
MACON, GA

BANK STABILIZATION
PLAN

PROJECT

TASK

FOR INFORMATION ONLY - DRIVE R/W VARIES

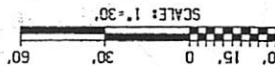

Original Design
JUNE 1999

IF YOU DIG IN GEORGIA ... CALL US
1-800-282-7411

ACTIVITY

WEEK 4	GRASSING
WEEK 3	PAVING
WEEK 2	SITE GRADING
WEEK 1	SEDIMENT & EROSION CONTROL
START	

CONSTRUCTION SCHEDULE



SPOT ELEVATIONS	•••••
CONTOURS	— — — — —
STRUCTURE	▭
RECAST HEADWALL	▭

SECTION 5+00

4+00

E OF WATER

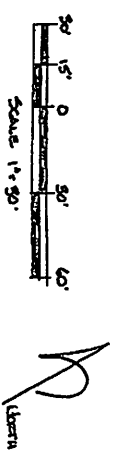
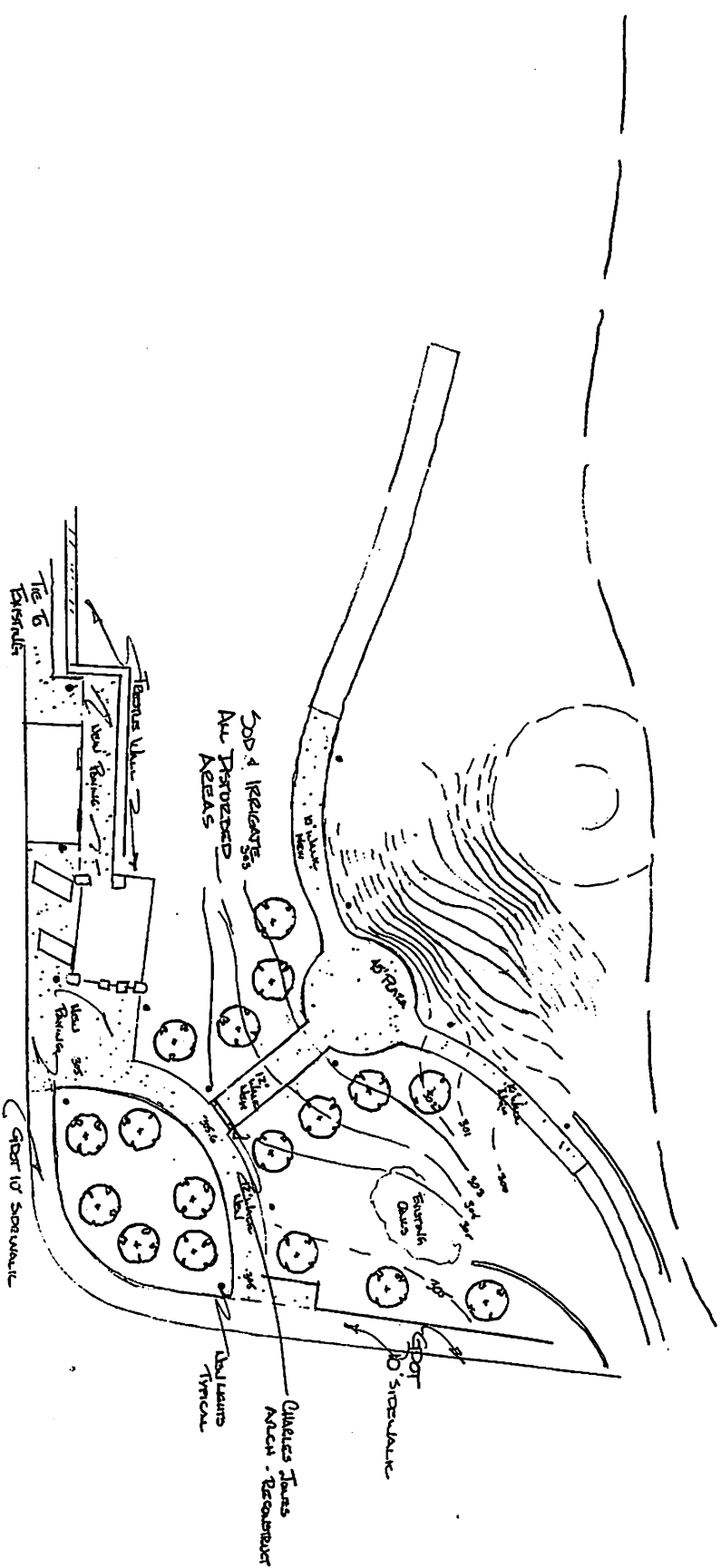

<p>GATEWAY PARK</p> <p>RENOVATION PLAN</p>	
<p>SCALE: 1/8" = 3'-0"</p> <p>DATE: FEBRUARY, 2010</p>	<p>DESIGNED BY: [Signature]</p> <p>REVIEWED: [Signature]</p>
<p>WALKER, RICE, GARDNER, TROTT, WALKER</p>	<p>DRAWING NUMBER:</p>

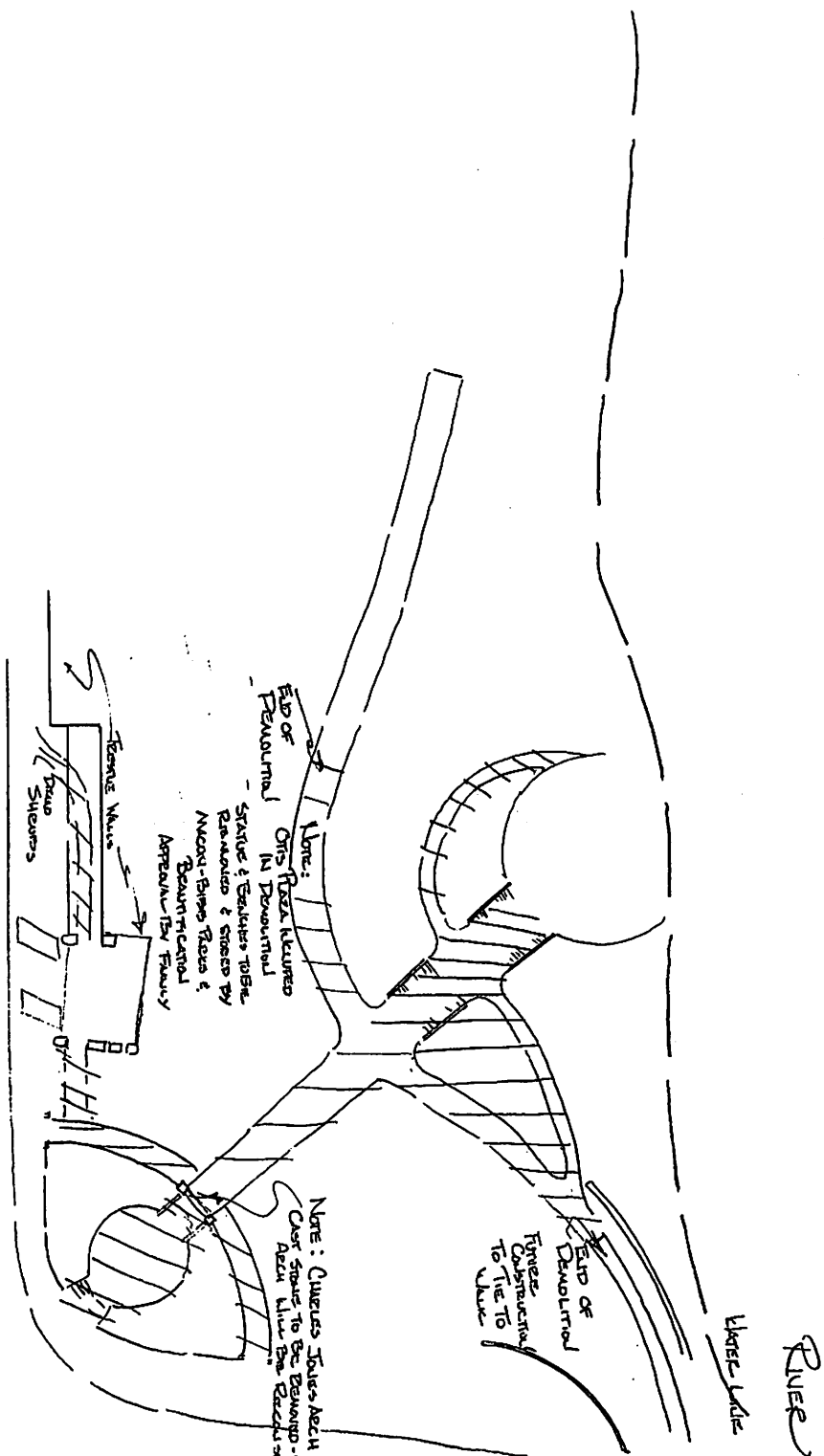

RIVER

Water Line

End of Demolition
Type Construction
To Tie To Wall

Note: Curious Joints Area.
Check Status to be Demolished - Uninsured & Stock
Area Must be Rechecked

Note: Status & Existing Jobs.
Removal & Staged by
Aerial - Pinned Areas &
Beam Critical
Apparatus Fully

Remove Wall
Remove Sluiceway

DEMOLITION PLAN	
SCALE: 1" = 30'-0"	DESIGNED BY:
DATE: APRIL 2021	DRAWN BY: L.H.
	REVISED:
	DRAWING NUMBER: